

# CONTOUR GONDOLA CHECKOUT KIT ASSEMBLY INSTRUCTIONS

## CONTOUR GONDOLA CHECKOUT COUNTER KIT ASSEMBLY INSTRUCTIONS

1. Gondola checkout counter is to be assembled over gondolas.
2. Hook flush top brackets (#2) so that the bracket tops are flush with the top of the gondolas, (#1).  
Note: Contour side does not require flush top bracket.
3. Place the counter top (#3) over the top of the gondolas and flush top brackets (#2).
4. Attach the end panel (#4) to the counter top using the cams and dowels for 8' or longer. (Not shown).
5. Attach the Z-clips (#5)-(2 Z-clip per side) between the end shoe and base with 3/4" screws.

\*Note: Gondola not included in kit.

## CONTOUR SIDE DOES NOT REQUIRE FLUSHTOP BRACKET

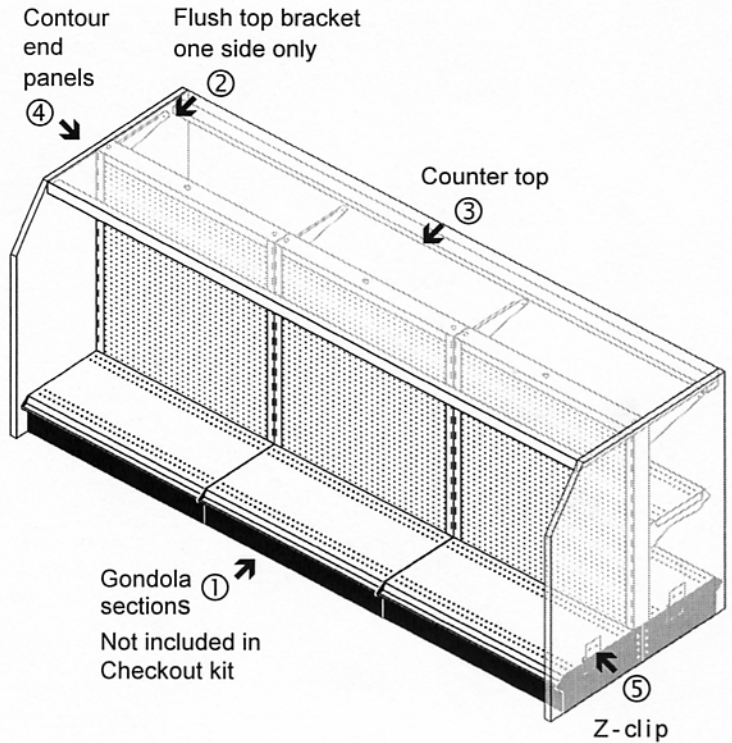
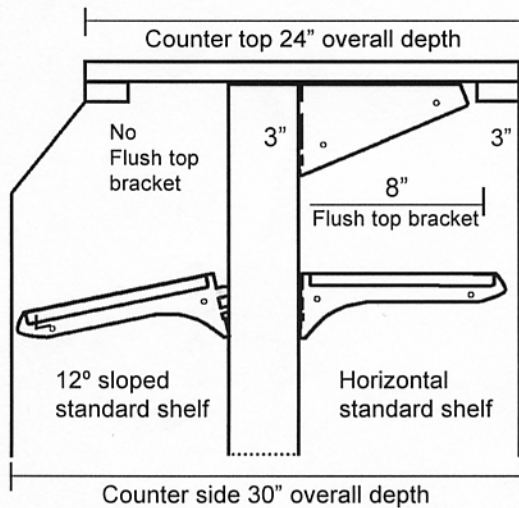

## CONTOUR GONDOLA CHECKOUT WITH 1" FRONT LIP ON 12° SLOPED HANDY STANDARD SHELVES

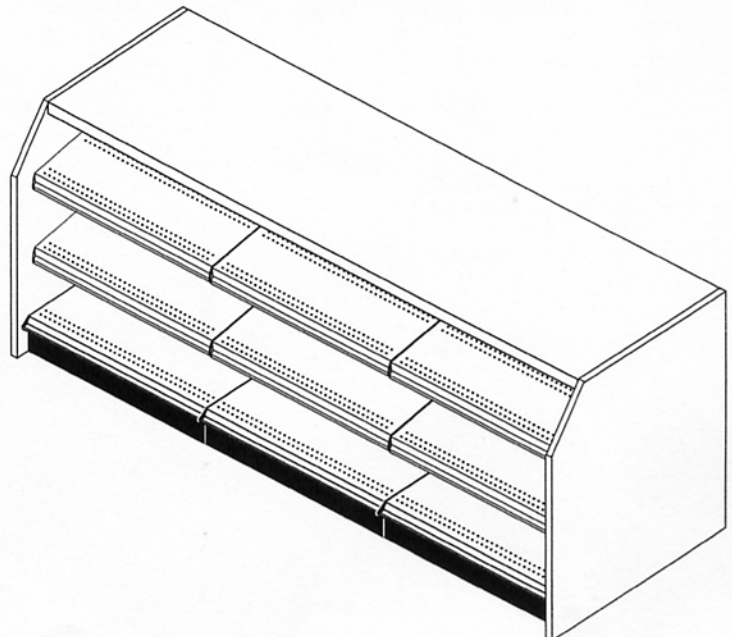

| GONDOLA CHECKOUT COUNTER KIT  |                    |  |
|-------------------------------|--------------------|--|
| No.                           | Description        | Part No.                               |
| #1                            | Gondolas           | See gondola assembly instruction sheet |
| Gondolas not included in kit  |                    |  |
| CHECKOUT COUNTER KIT INCLUDES |                    |  |
| #2                            | Flush Top Brackets | FTB + Depth                            |
| #3                            | Counter Top        | PART NO. CHKT plus angle degree        |
| #4                            | End Panels         |  |
| #5                            | Z-Clip             |  |
| #6                            | Dowels & Cams      | Not shown, located inside counter      |