

SEE-THRU GONDOLA RUN ASSEMBLY INSTRUCTION

SEE-THRU GONDOLA RUN ASSEMBLY PART LIST

No.	# of parts	Descriptions	
1	2	End upright right/left	Factory pre-assembled
	6	Leveling screws #9	Boiled to shoes #2
	2	Top cap screws	Boiled to upright #1
2	4	End Shoes: right/left	Welded of upright #1
1A	2	Center upright right/left	Factory pre-assembled
	6	Leveling screws #9	Boiled to shoes #2A
	2	Top cap screws	Boiled to upright #1A
2A	2	Center Shoes: right/left	Welded of upright #1A
5	6	Front toes	Part #: FTO48
5A	6	Back toes	Part #: BTO48
5B	24	5/8x1/4-20 Bolts and 1/4-20 Nuts	
6	6	Base shelves	BSF+width+depth
9	12	Leveling screws	Factory pre-assembled
15	2	End see-thru frame	3/4" sq. tubing
16	4	Inside end upright cap	
16A	2	Inside center upright cap	
17	2	End base filler cap	Part #: BFC45
17A	1	Center base filler cap	Part #: BFC46
17B	1	See-thru Wall unit base filler cap	
18	2	End See-thru top cap with U's	
18A	1	Center See-thru top cap with tabs	

INSTRUCTIONS:

- Slide front toes #5, into end shoes #2 & center shoe #2A.
 - Slide back toes 5A & bolt it to upright #1 & #1A, using nuts and bolts, #5B
 - Place End See-thru Frame #15, between the upright tabs #1B, and rest it on the peg stop clip #1C. (See-thru frame is to be cased in every other section. Not need in center, add-on section.)
 - Place see-thru frame vertical end-upright caps #16, over vertical bars of the 3/4"sq. tubing frame #15, and rest them on the bottom of the horizontal bar of the See-thru frame.
 - Center Unit without frame. Place the center vertical upright caps #16A, over uprights #1A, and rest on peg stop clip #1C.
 - Screw on see-thru end top cap with U's #18, over frame #15.
 - Screw on see-thru center top cap with tabs #18A, over unit uprights #1A without frame.
 - Level the unit with leveling screws #9.
 - Hook in base shelves #6, into uprights and rest it on front shoes #5.
 - Insert base filler caps #17 and #17a, between base shelves #6.
- * See-Thru Wall Units base filler caps are narrower #17B

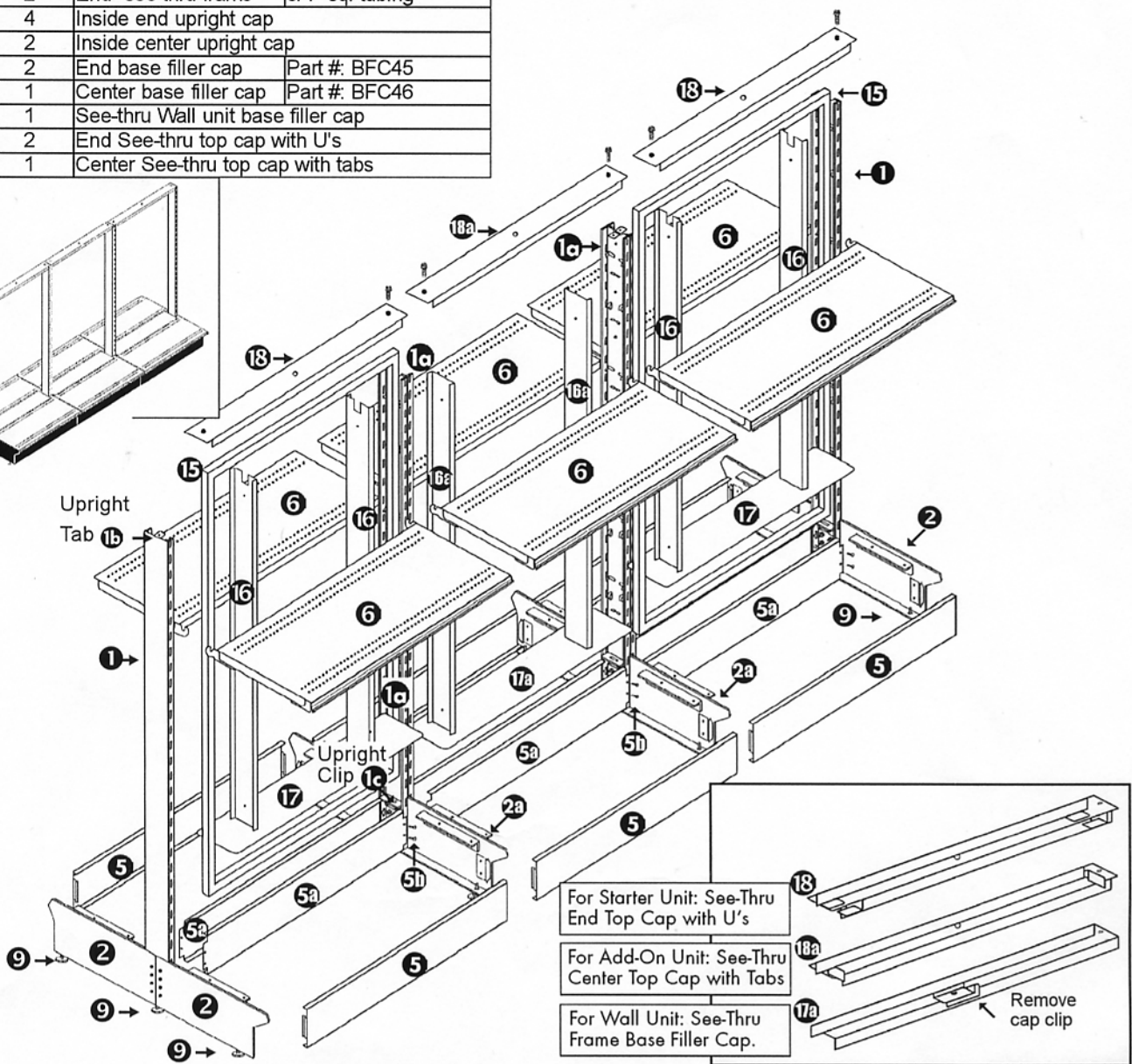

For Starter Unit: See-Thru End Top Cap with U's

For Add-On Unit: See-Thru Center Top Cap with Tabs

For Wall Unit: See-Thru Frame Base Filler Cap.

